

# Bolted Closure

## Pressure Vessel

**Volume:** 300 ml to 7.57 L

**Vessel MAWP\*:** 2,000 to 6,000 psi @ 72°F (138 to 413 bar @ 22°C)  
(Reduced pressures available up to 1,400°F)

**Material of Construction:** 316 Stainless Steel

\* Maximum Allowable Working Pressure

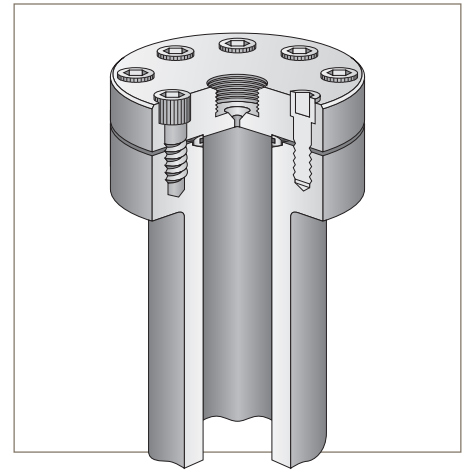

### Principle of Operation:

The Parker Autoclave Engineers Bolted Closure (confined gasket) pressure vessels are widely accepted for their simplicity, ease of assembly and flexibility. Particularly suited to applications calling for agitation, they are full-opening with the entire vessel I.D. available for cover openings and connections. Additional openings can be machined in the body flange and bottom of vessel. Parker Autoclave Engineers Bolted Closure vessels feature the Gasche™ confined gasket design for reliable sealing even at very high temperatures. It is shaped to effect a tight metal-to-metal seal on the body and cover and is reusable over many openings and closings of the vessel.

### General Specifications:

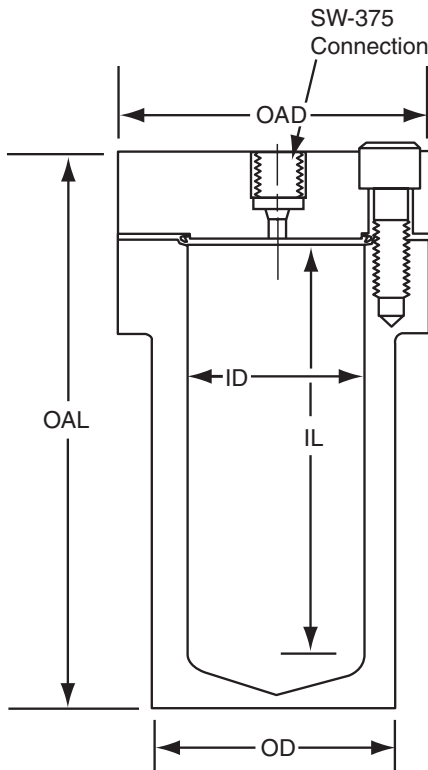

Model Drawing #	Nominal Capacity	Dimensions - inches (mm)				
		ID	OD	IL	OAL	OAW
BC0030SS0510A-2496	300 ml	1.81" (46)	2.56" (65)	7.13" (181)	9.50" (241)	4.13" (105)
BC0100SS0610A-2497	1000 ml	3.00" (76)	4.38" (111)	9.06" (230)	12.25" (311)	5.56" (141)
BC0200SS0510A-2498	2000 ml	3.50" (89)	5.00" (127)	13.00" (330)	16.56" (421)	6.44" (163)
BC0378SS0510A-2500	3.78 L	5.00" (127)	7.12" (181)	12.00" (305)	17.03" (433)	8.88" (225)
BC0757SS0510A-2502	7.57 L	5.00" (127)	7.12" (181)	24.00" (610)	28.75" (730)	8.88" (225)
BC0378SS0310A-2499	3.78 L	5.00" (127)	6.25" (159)	12.00" (305)	16.06" (408)	8.12" (206)
BC0757SS0310A-2501	7.57 L	5.00" (127)	6.25" (159)	24.00" (610)	28.00" (711)	8.12" (206)
WB0757SS0310A-5877	7.57 L wide body	6.50" (165)	8.06" (205)	14.00" (365)	18.79" (477)	10.50" (267)

**NOTES:**

Wrench flats are supplied on 300 ml and 1 Liter bodies at bottom to aid in tightening bolts.

Alloy steel cap screws supplied with order number above. For Type 316 SS cap screws, see table on page 2.  
Other inside lengths can be supplied on special order; consult factory for availability.



ENGINEERING YOUR SUCCESS.

## MAWP vs. Temperature Rating (standard 316 SS body, cover and seal ring)

ALLOY STEEL (B-16) CAP SCREWS	Model	°F	to 100°	200°	300°	400°	500°	600°	650°	700°	800°	850°	900°	950°	1000°	1050°	1100°
		°C	to 37.8°	93°	148°	204°	260°	315°	343°	371°	426°	454°	482°	510°	537°	565°	593°
	BC0030SS05	psi (bar)	6000 (414)	6000 (414)	5925 (409)	5850 (400)	5850 (400)	5400 (372)	1075 (74)	5250 (362)	5125 (353)	5075 (350)	5000 (345)	4975 (343)	3925 (271)	2250 (155)	1000 (69)
	BC0100SS06	psi (bar)	6000 (414)	6000 (414)	5925 (409)	5825 (402)	5825 (402)	5825 (402)	5800 (400)	5650 (390)	5500 (379)	5450 (376)	5400 (372)	5325 (367)	3650 (252)	2075 (143)	925 (63)
	BC0200SS05	psi (bar)	5750 (396)	5750 (396)	5625 (388)	5525 (381)	5525 (381)	5525 (381)	5500 (379)	5350 (369)	5225 (360)	5150 (355)	5125 (353)	5050 (348)	3825 (264)	2175 (150)	975 (67)
	BC0378SS05 BC0757SS05	psi (bar)	5750 (396)	5750 (396)	5625 (388)	5525 (381)	5525 (381)	5525 (381)	5500 (379)	5350 (369)	5225 (360)	5150 (355)	5125 (353)	5050 (348)	4075 (281)	2325 (160)	1025 (70)
	BC0378SS03 BC0757SS03	psi (bar)	3450 (238)	3450 (238)	3375 (233)	3300 (228)	3300 (228)	3300 (228)	3300 (228)	3200 (221)	3125 (215)	3100 (214)	3075 (212)	3000 (207)	2050 (141)	1175 (81)	525 (36)
	WB0757SS03 wider body	psi (bar)	3600 (248)	3600 (248)	3525 (243)	3450 (238)	3450 (238)	3450 (238)	3450 (238)	3350 (231)	3275 (226)	3225 (222)	3200 (221)	3175 (219)	2600 (179)	1475 (102)	650 (44)

TYPE 316 STAINLESS STEEL (B-8M) CAP SCREWS	Model	°F	to 100°	200°	300°	400°	500°	600°	650°	700°	800°	850°	900°	950°	1000°	1050°	1100°
		°C	to 37.8°	93°	148°	204°	260°	315°	343°	371°	426°	454°	482°	510°	537°	565°	593°
	BM0030SS04	psi (bar)	6000 (414)	5750 (396)	5225 (360)	4750 (327)	4475 (309)	4225 (291)	4100 (283)	4050 (279)	3925 (271)	3900 (269)	3850 (265)	3825 (264)	3800 (262)	3750 (259)	3675 (253)
	BM0100SS04	psi (bar)	6000 (414)	5350 (369)	4850 (334)	4425 (305)	4150 (286)	3925 (271)	3825 (264)	3750 (259)	3650 (252)	3625 (250)	3575 (246)	3550 (245)	3525 (243)	3475 (240)	3425 (236)
	BM0200SS04	psi (bar)	5750 (396)	5600 (386)	5075 (350)	4625 (319)	4350 (300)	4100 (283)	4000 (276)	3925 (271)	3825 (264)	3775 (260)	3750 (259)	3725 (253)	3675 (253)	3650 (252)	3575 (246)
	BM0378SS04 BM0757SS04	psi (bar)	5750 (396)	5750 (396)	5425 (374)	4925 (340)	4625 (319)	4375 (302)	4250 (293)	4175 (288)	4075 (281)	4050 (279)	4000 (276)	3975 (274)	3925 (271)	3900 (269)	3825 (264)
	BM0378SS02 BM0757SS02	psi (bar)	3525 (243)	3000 (207)	2725 (188)	2475 (171)	2325 (160)	2200 (152)	2150 (148)	2100 (145)	2050 (141)	2025 (140)	2025 (140)	2000 (138)	1975 (136)	1950 (134)	1925 (133)
	WM0757SS03 wider body	psi (bar)	3600 (248)	3600 (248)	3425 (236)	3125 (215)	2950 (203)	2775 (191)	2700 (186)	2650 (183)	2600 (179)	2550 (176)	2550 (176)	2525 (174)	2500 (172)	2475 (171)	2425 (167)
	Model	°F	1150°	1200°	1250°	1300°	1350°	1400°									
		°C	612°	649°	677°	704°	732°	760°									
BM0030SS04	psi (bar)	3150 (217)	2375 (164)	1775 (122)	1325 (91)	1000 (68)	725 (50)										
BM0100SS04	psi (bar)	3075 (212)	2450 (169)	1775 (122)	1350 (93)	975 (67)	725 (50)										
BM0200SS04	psi (bar)	3225 (222)	2425 (167)	1800 (124)	1350 (931)	1025 (70)	750 (51)										
BM0378SS04 BM0757SS04	psi (bar)	3225 (222)	2450 (169)	1800 (124)	1350 (93)	1000 (68)	800 (55)										
BM0378SS02 BM0757SS02	psi (bar)	1725 (119)	1375 (94)	1000 (68)	750 (51)	550 (37)	400 (27)										
WM0757SS03 wider body	psi (bar)	2000 (138)	1525 (105)	1125 (77)	825 (56)	625 (43)	500 (34)										

CAUTION: Sensitization occurs over the temperature range from 850° F to 1475° F (454° C to 802° C). This is a harmful grain boundary condition affecting corrosion resistance of austenitic alloys.

## Special Materials: Pressure vs. Temperature

Material		316 SS (standard)	Hastelloy-B	Hastelloy-C	Titanium	Inconel	Monel	Nickel
Temperature Rating at MAWP		@650°F (343°C)	@650°F (343°C)	@650°F (343°C)	@600°F (316°C)	@650°F (343°C)	@650°F (343°C)	@600°F (316°C)
Vessel Number		Maximum Allowable Working Pressure						
BC0030	psi (bar)	5400 (372)	6000 (414)	6000 (414)	1875 (129)	6000 (414)	4325 (298)	3300 (228)
BC0100	psi (bar)	5800 (400)	6000 (414)	6000 (414)	2000 (138)	6000 (414)	4625 (319)	3525 (243)
BC0200	psi (bar)	5500 (379)	6000 (414)	6000 (414)	1925 (133)	6000 (414)	4450 (307)	3400 (234)
BC0378 BC0757	psi (bar)	5500 (379)	6000 (414)	6000 (414)	1925 (133)	6000 (414)	4425 (305)	3375 (233)
BC0378 BC0757	psi (bar)	3300 (228)	5625 (322)	4675 (322)	1175 (810)	4150 (286)	2700 (186)	2075 (143)
WB0757 wider body	psi (bar)	3450 (238)	5750 (396)	4925 (340)	1200 (827)	4225 (291)	2775 (191)	2100 (145)

## Removable Liners:

Most Bolted vessels are available with welded loose-fitting liners of 16-gage material. When ordering, specify Type 316 ss ("SS"), titanium ("TI"), Inconel ("IN"), nickel ("NI"), Hastalloy® B ("HB"), Hastalloy® C ("HC"), Monel ("MO"), or glass ("GL").

## Recommended Cap Screw Torque

Vessel Catalog Order Number	Recommended Torque	
	For Normal Conditions	To Deform New Gasket in a Used Body and Cover
BC0030SS05	40 ft lbs (5.5 KgM)	50 ft lbs (7.0 KgM)
BC0100SS06	60 ft lbs (8.0 KgM)	90 ft lbs (12.0 KgM)
BC0200SS05	100 ft lbs (14.0 KgM)	125 ft lbs (17.0 KgM)
BC0378SS05	275 ft lbs (38.0 KgM)	350 ft lbs (48.4 KgM)
BC0757SS05	275 ft lbs (38.0 KgM)	350 ft lbs (48.4 KgM)
BC0378SS03	150 ft lbs (21.0 KgM)	190 ft lbs (26.0 KgM)
BC0757SS03	150 ft lbs (21.0 KgM)	190 ft lbs (26.0 KgM)
BC0757SS03 wider body	215 ft lbs (30.0 KgM)	235 ft lbs (32.0 KgM)

Torque values above are recommended when vessel is to be operated at full rated pressure; lower torque may be used for lower pressure operation.

## Optional O-Ring Gasket:

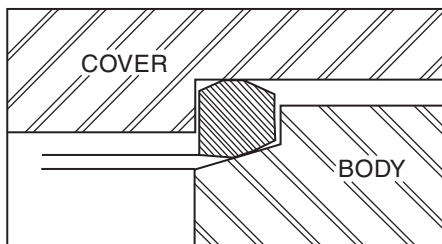

## Optional O-Ring Chart:

Material	Max. Temperature	
	° F	° C
Buna N	250°	(121°)
EFR	300°	(149°)
Silicone	400°	(204°)
* Viton®	450°	(232°)
PTFE Encapsulated * Viton®	450°	(232°)
* Kalrez®	500°	(260°)

\* Products are registered trademarks of Dupont Dow Elastomers.

# The Gasche™ Gasket

Parker Autoclave Engineers Bolted Closure vessels feature the Gasche™ confined gasket design for reliable sealing even at very high temperatures. It is shaped to effect a tight metal-to-metal seal on the body and cover and is reusable over many openings and closings of the vessel.

## Ordering Guide:

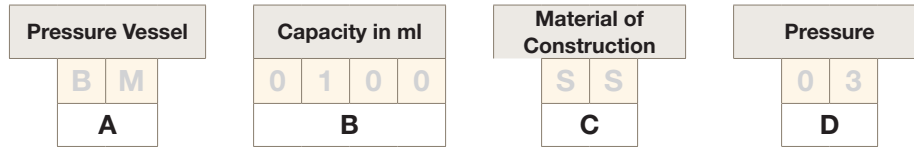

Part Number Example: **BM0100SS03** (example selections indicated in yellow below)

A - Pressure Vessel	
<b>WB</b>	Wider Body
<b>BM</b>	B8M Cap Screws

B - Capacity	
<b>0030</b>	300 ml
<b>0100</b>	1000 ml
<b>0200</b>	2000 ml
<b>0378</b>	3.78 L
<b>0757</b>	7.57 L

C - Material of Construction	
<b>SS</b>	316 Stainless Steel
<b>HB</b>	Hastelloy® C276
<b>HC</b>	Hastelloy® C276
<b>TI</b>	Titanium
<b>IN</b>	Inconel
<b>MO</b>	Monel
<b>NI</b>	Nickel

D - Pressure: psi (bar)	
<b>03</b>	3000 (207)
<b>05</b>	5000 (345)
<b>06</b>	6000 (414)

\* Pressure rating will vary based on temperature and material of construction

\* Hastelloy® is a registered trademark of Haynes International, Inc.

## Features and Available Options:

- Different Connections
- Other Materials of Construction
- Heaters and Furnaces
- Stand (Bench or Floor Style)
- ASME Code Stamp, CRN Registration
- Liners
- Consult Factory to discuss your specific requirements

## Supporting Information:

Please refer to the following sections of the catalog for complimentary products and additional technical details.

- **“MagneDrives®”** - (Agitation Section, Bulletin AG-SG)
- **“Controls”** - (Instrumentation Section, Bulletin IN-SG)
- **“Complete Systems”** - (Stirred Reactor Section, Bulletin SR-SG)
- **“Valves, Fittings, Tubing”** - (VFT Catalog, [www.autoclave.com](http://www.autoclave.com))

### WARNING

**FAILURE, IMPROPER SELECTION OR IMPROPER USE OF THE PRODUCTS AND/OR SYSTEMS DESCRIBED HEREIN OR RELATED ITEMS CAN CAUSE DEATH, PERSONAL INJURY AND PROPERTY DAMAGE.**  
 This document and other information from Parker Hannifin Corporation, its subsidiaries and authorized distributors provide product and/or system options for further investigation by users having technical expertise. It is important that you analyze all aspects of your application and review the information concerning the product or system in the current product catalog. Due to the variety of operating conditions and applications for these products or systems, the user, through its own analysis and testing, is solely responsible for making the final selection of the products and systems and assuring that all performance, safety and warning requirements of the application are met. The products described herein, including without limitation, product features, specifications, designs, availability and pricing, are subject to change by Parker Hannifin Corporation and its subsidiaries at any time without notice.

### Offer of Sale

The items described in this document are available for sale by Parker Hannifin Corporation, its subsidiaries or its authorized distributors. Any sale contract entered by Parker will be governed by the provisions stated in Parker's standard terms and conditions of sale (copy available upon request).

©2015 Parker Hannifin Corporation | Autoclave Engineers is a registered trademark of the Parker Hannifin Corporation

06-0054SE June2015



**Instrumentation Products Division**  
 Autoclave Engineers Operation  
 8325 Hessinger Drive  
 Erie, PA 16509-4679  
 Tel: 814 860 5700 • Fax: 814 860 5718  
[www.AutoclaveEngineers.com](http://www.AutoclaveEngineers.com)

**Caution!** Do not mix or interchange component parts or tubing with those of other manufacturers. Doing so is unsafe and will void warranty.  
**Caution!** Parker Autoclave Engineers Valves, Fittings, and Tools are not designed to interface with common commercial instrument tubing and are designed to only connect with tubing manufactured to Parker Autoclave Engineers AES specifications. Failure to do so is unsafe and will void warranty.

Bulletin PV-BC

ENGINEERING YOUR SUCCESS.